

FCA 160 & 120

Automatic Double-Clipper



innovative · reliable · leading

poly-clip[®]
SYSTEM

FCA 160 & 120

FCA 160

For the 38 – 160 mm calibre range at up to 160 cycles per minute

FCA 120

For the 24 – 120 mm calibre range at up to 250 cycles per minute

- Automatic, self-regulating processes for maximum productivity
- Voiding separator and clip shape optimised for short sausage shoulders and more slices per sausage
- Centralised lubrication for maximum reliability and service life



FCA 160 – powerful machine for large calibres

Applications

FCA 160

The FCA 160 offers unrivalled versatility in an automatic clipper. It closes all fibrous and collagen casings up to 120 mm (depending on the material thickness), plastic casings up to 160 mm. The automatic double-clipper closes the R-ID clip sizes M, L and XL.

FCA 120

The FCA 120 is characterised by a maximum speed at up to 250 cycles. It closes all fibrous and collagen casings up to 65 mm and plastic casings up to 120 mm. Maximum flexibility is achieved by the use of the R-ID clip sizes S and M.

Advantages

- Automatic self-monitoring process for maximum productivity
- Incorrect settings are avoided by detection of the clip size, the die and the separator hole, combined with clip pressure setting
- R-ID clip: tighter clip, even up to bacteria-proof sealing depending on the casing
- Clip monitoring for full utilization of the clip wire per reel
- Neat pleating and clean sausage tails due to the vertical voiding separator

- Robustness and long service life guaranteed by use of high-tech materials
- Five speeds plus continuous mode for maximum product versatility
- Simple machine operation with EASY TOUCH, product parameters can be recalled from the programme memory
- Change of clip spacing quickly without tools and of spreading with just a few hand grips
- Operator safety by two-hand triggering of first clip
- Electronic hand-wheel for adjustments and setting parameters
- Product true to the calibre by adjustable conveyor speed
- Stainless steel provides resistance to aggressive cleaning solutions
- Air-free slack filling of moulded products by overspreading, total spreading up to 130 or 90 mm
- Simple ergonomic handling with the pneumatic swing-off and swing-on assistance
- Easy to manoeuvre with integral front wheel, retractable steering bar and twin turret with link rod
- Completely sealed switchbox can be withdrawn and swivelled upwards 90 degrees
- Low noise level
- Smooth surfaces make for easy cleaning
- Optimum accessibility for maintenance afforded by swing-off outer covers

Vertical voiding separator means short sausage shoulders with clean ends



Overspreading for air-free slack filling of moulded products



Optional equipment

- Central lubrication, machine cycle-dependent, for maximum reliability and service life
- Automatic looper (GSA 20), loop on the left or on the right
- Swivelling twin turret, casing change without swing-out of the clip head
- Servo-assisted clip pressure setting, retrievable as product parameter
- Faster handling due to semi-automatic clip guidance
- Spreading and overspreading servo-assisted
- Sensors for no-loops and casing end
- Pneumatic dry sausage brake, movable or fixed
- Casing brake safety sensor
- Length portioning by means of optical scanning
- String dispenser for rings
- Registration control for centred printing format
- Filler coupling with ball joint
- Sausage tray for FCA 120
- Conveyor and roller conveyor, including extension, variants to suit product
- Single clip feature
- Clip coding
- Water-trickle application for casings, spray system for films
- Net applicator

The FCA series with smooth surfaces of stainless steel for ease of cleaning



FCA 120 - the specialist machine for high speed production of calibres up to 120 mm

Function and operation

The automatic double clipper is connected mechanically and synchronized electrically to a filling machine. The portions are fed in precisely to the nearest gram and closed by a clip. A thorough process monitoring is guaranteed by the high degree of automation of the FCA. If there are deviations from the product programmes' set of parameters stored in the EASY TOUCH, the control system corrects automatically or a message is displayed. The operator is guided intuitively through the flat menu structure with informative icons and can easily control the complete machine at the touch of a finger. Operator, set-up and service levels are clearly separated and password protected. The automated operation offers the greatest product safety and maximum efficiency.

Combinability

- TSA 120 & 200** – seals a ready-to-fill tube of flat roll stock film in-line
- AHL 1000** – automatic hanging of looped products
- ES 5000** – labelling system for marking and traceability

Clip System Solutions

The complete machine, clip and loop system from one source ensures efficient, trouble-free production. The Original Clip from Poly-clip guarantees top quality. Manufactured to strictest quality standards, certified to ISO 9001:2000 and tuned precisely to the production process. The patented genuine, food-proof, safety coating using Poly-clip SAFE-COAT technology ensures trouble-free production and a no-worry product warranty. Poly-clip System is the world's leading provider of Clip System Solutions.

Continuous production and substantial cost savings: FCA 160 combined with the TSA 200



FCA 160 & 120

Dimensions (in mm)

Technical data

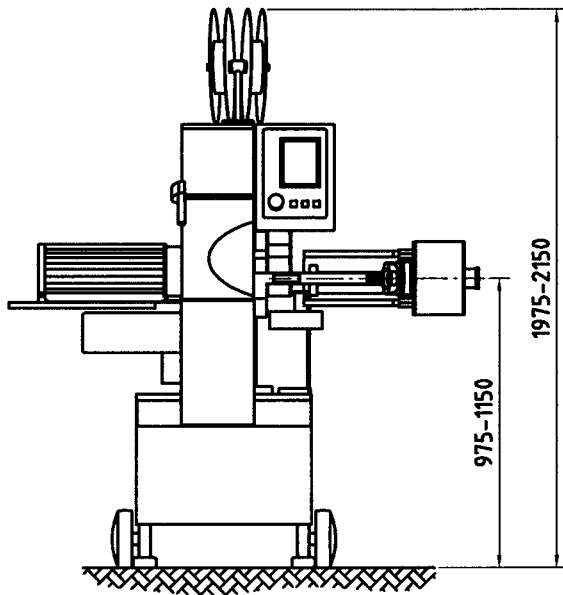

Front view

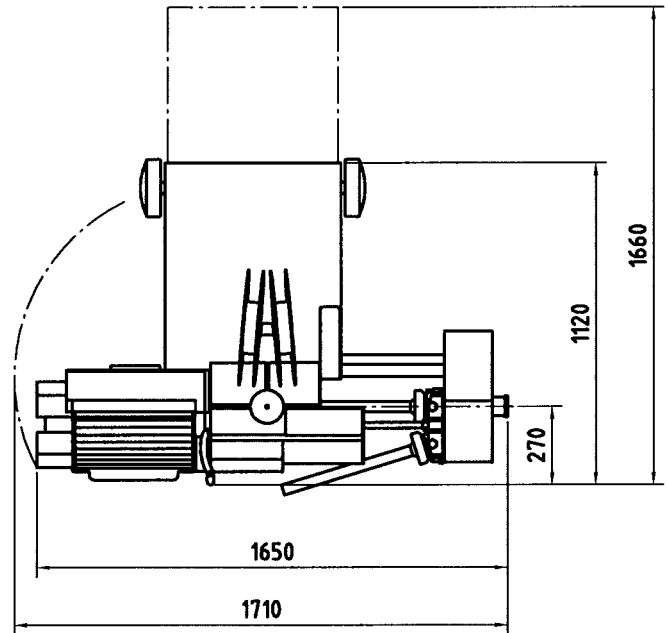

Top view

	FCA 160	FCA 120
Width:	1 650-1 710 mm	1 650-1 710 mm
Depth:	1 120-1 660 mm	1 120-1 660 mm
Height:	1 975-2 150 mm	1 975-2 150 mm
Weight:	610 kg	610 kg
Three phase current connection:	200-230 VAC, 380-460 VAC, 50 or 60 Hz	
Power input:	4 kW	4 kW
Fuse connection:	16 A	16 A
Compressed air:	5-7 bar/0.5-0.7 MPa	5-7 bar/0.5-0.7 MPa
Air consumption:	1.6 NL/cycle	1.6 NL/cycle
R-ID clip:	M, L, XL	S, M
Spreading:	26, 30, 36, 44 mm	18, 26, 30 mm
Incl. overspreading up to:	130 mm	90 mm

FCA 160 & 120-GB-04/08-HA Subject to technical modifications.

